



Graf-Adolf-Platz 15, Düsseldorf

A GLOWING LOCATION

Concept

In connection with the 90 m high office building, GAP 15, new development work was carried out on the Graf-Adolf-Platz. The task was to restructure the urban space, define it more precisely, and make it tangible again.

The existing setting, which was characterized primarily by streets and traffic, was radically simplified: floor paving across the whole square, the "elevation" of the park through a gentle modelling of the ground and 40cm-high, metallic green steel borders, the preservation of all the park trees and the removal of the entire shrub-like undergrowth.

The "Mikado" motif of road axes and white illuminated benches between the exclusive shopping street Königsallee and the 21st century art collection of the K21 is the main feature of the design draft.

Low-key arrangements of seating and steles made of natural stone mark the areas in which people are encouraged to linger. A particularly striking element is the very long, linear seating elements made of translucent plastic that are spread across the space like Mikado sticks, extending into the adjacent urban spaces. They creatively enclose the square and transform it into an art space at night. As both sculptural seating and light objects, they very much contribute to giving the Graf-Adolf-Platz a distinct identity.

Client

GAP 15 GMBH, DÜSSELDORF
IKB DEUTSCHE INDUSTRIEBANK AG, DÜSSELDORF

Project period

2002-2005

Size

19.250 m²

Type

PUBLIC SPACES & SQUARES

Location

DÜSSELDORF, GERMANY

Competition

1. PRIZE „GAP 15“, 2002

Realisation

WES & PARTNER

Partner

J.S.K DIPL. ING. ARCHITEKTEN, DÜSSELDORF

CONTACT

Jarrestraße 80
22303 Hamburg
Germany

Telephone +49 (0) 40 2 78 41-0
Telefax +49 (0) 40 270 66 68
hamburg@wes-la.de

FOR MORE INFORMATION AND PRESS MATERIAL

Telephone +49 (0) 40 2 78 41-153
Telefax +49 (0) 40 270 66 68
pr@wes-la.de

Publications

Trade journal „Garten + Landschaft“ **Graf-Adolf-Platz 15 (GAP15)**

Author: Anette Kolkau

Callwey-Verlag, No. 1/2007

Trade magazine „Wirtschaft & Architektur Rheinland“ **eues Wahrzeichen in Düsseldorf, GAP 15**

Author: Sascha Gumbinger

VSG Medien, Worms, No. 4/2006

Magazine „TASPO Garten Design“ **GAP 15: Mikado aus Licht und Wegeachsen**

Author: Imma Schmidt

Thalacker Medien, No. 2 - 4/2006

Book **Pläne Projekte Bauten Düsseldorf: Architektur und Städtebau in Düsseldorf 2005 bis 2015**

Author: Joachim Erwin

Verlagshaus Braun, Berlin, 2006

Book der Stiftung Schloss und Park Benrath **Düsseldorfer Gartenkunst nach 1945**

Author: Eva-Maria Gruben

Museum für Europäische Gartenkunst, Stadt-Bild-Verlag, 2005

Exhibition **WES & Partner. Landscape architects**

WES & Partner

Genoa showroom for contemporary architecture and art, 2004-2005

Book **Stadtplätze: Architektur und Freiraumplanung**

Author: Jürgen Knirsch

Verlagsanstalt Alexander Koch, 2004

Awards

Nomination Building of the year 2008

Architekten- und Ingenieurverein (AIV) Düsseldorf, 2008

Recognition Good Building Award 2006

Association of German Architects (BDA) Düsseldorf

CONTACT

Jarrestraße 80
22303 Hamburg
Germany

Telephone +49 (0) 40 2 78 41-0
Telefax +49 (0) 40 270 66 68
hamburg@wes-la.de

FOR MORE INFORMATION AND PRESS MATERIAL

Telephone +49 (0) 40 2 78 41-153
Telefax +49 (0) 40 270 66 68
pr@wes-la.de

Project Images



CONTACT

Jarrestraße 80
22303 Hamburg
Germany

Telephone +49 (0) 40 2 78 41-0
Telefax +49 (0) 40 270 66 68
hamburg@wes-la.de

FOR MORE INFORMATION AND PRESS MATERIAL

Telephone +49 (0) 40 2 78 41-153
Telefax +49 (0) 40 270 66 68
pr@wes-la.de

Project Images



CONTACT

Jarrestraße 80
22303 Hamburg
Germany

Telephone +49 (0) 40 2 78 41-0
Telefax +49 (0) 40 270 66 68
hamburg@wes-la.de

FOR MORE INFORMATION AND PRESS MATERIAL

Telephone +49 (0) 40 2 78 41-153
Telefax +49 (0) 40 270 66 68
pr@wes-la.de

Project Images



CONTACT

Jarrestraße 80
22303 Hamburg
Germany

Telephone +49 (0) 40 2 78 41-0
Telefax +49 (0) 40 270 66 68
hamburg@wes-la.de

FOR MORE INFORMATION AND PRESS MATERIAL

Telephone +49 (0) 40 2 78 41-153
Telefax +49 (0) 40 270 66 68
pr@wes-la.de

Project Images

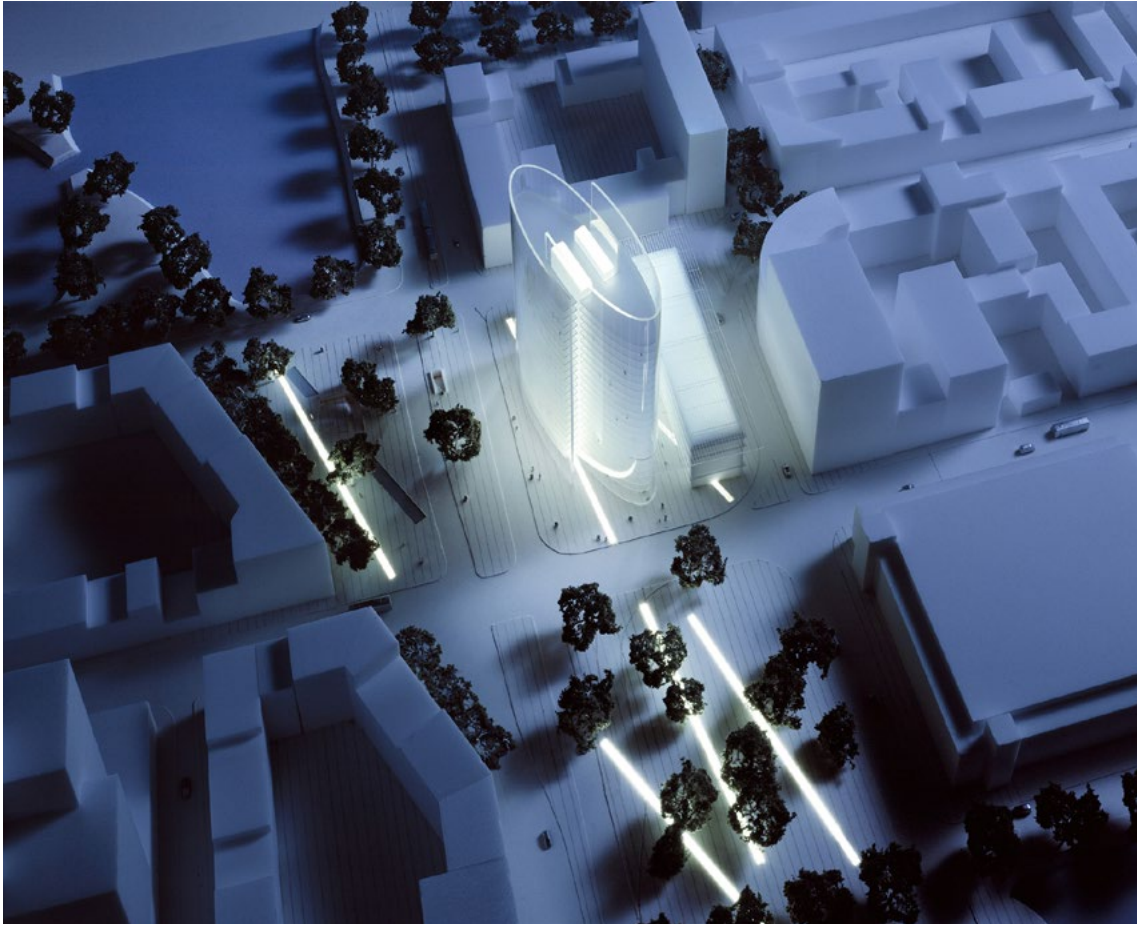

CONTACT

Jarrestraße 80
22303 Hamburg
Germany

Telephone +49 (0) 40 2 78 41-0
Telefax +49 (0) 40 270 66 68
hamburg@wes-la.de

FOR MORE INFORMATION AND PRESS MATERIAL

Telephone +49 (0) 40 2 78 41-153
Telefax +49 (0) 40 270 66 68
pr@wes-la.de

Project Images

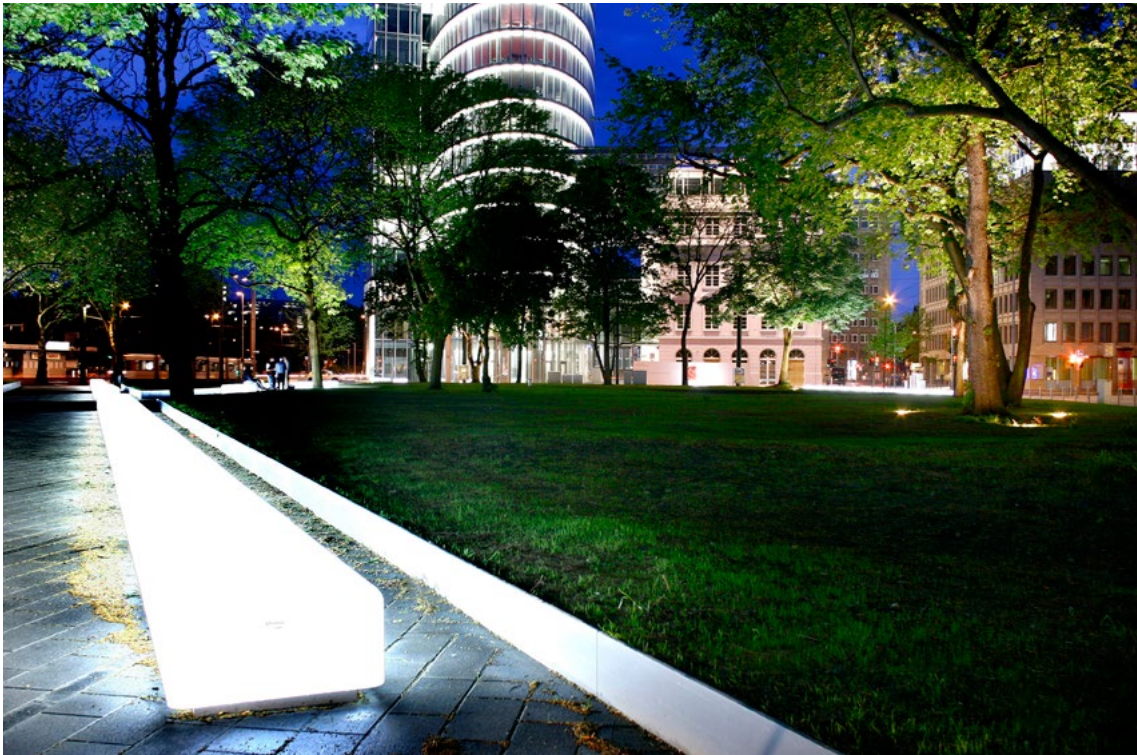

CONTACT

Jarrestraße 80
22303 Hamburg
Germany

Telephone +49 (0) 40 2 78 41-0
Telefax +49 (0) 40 270 66 68
hamburg@wes-la.de

FOR MORE INFORMATION AND PRESS MATERIAL

Telephone +49 (0) 40 2 78 41-153
Telefax +49 (0) 40 270 66 68
pr@wes-la.de

Project Images

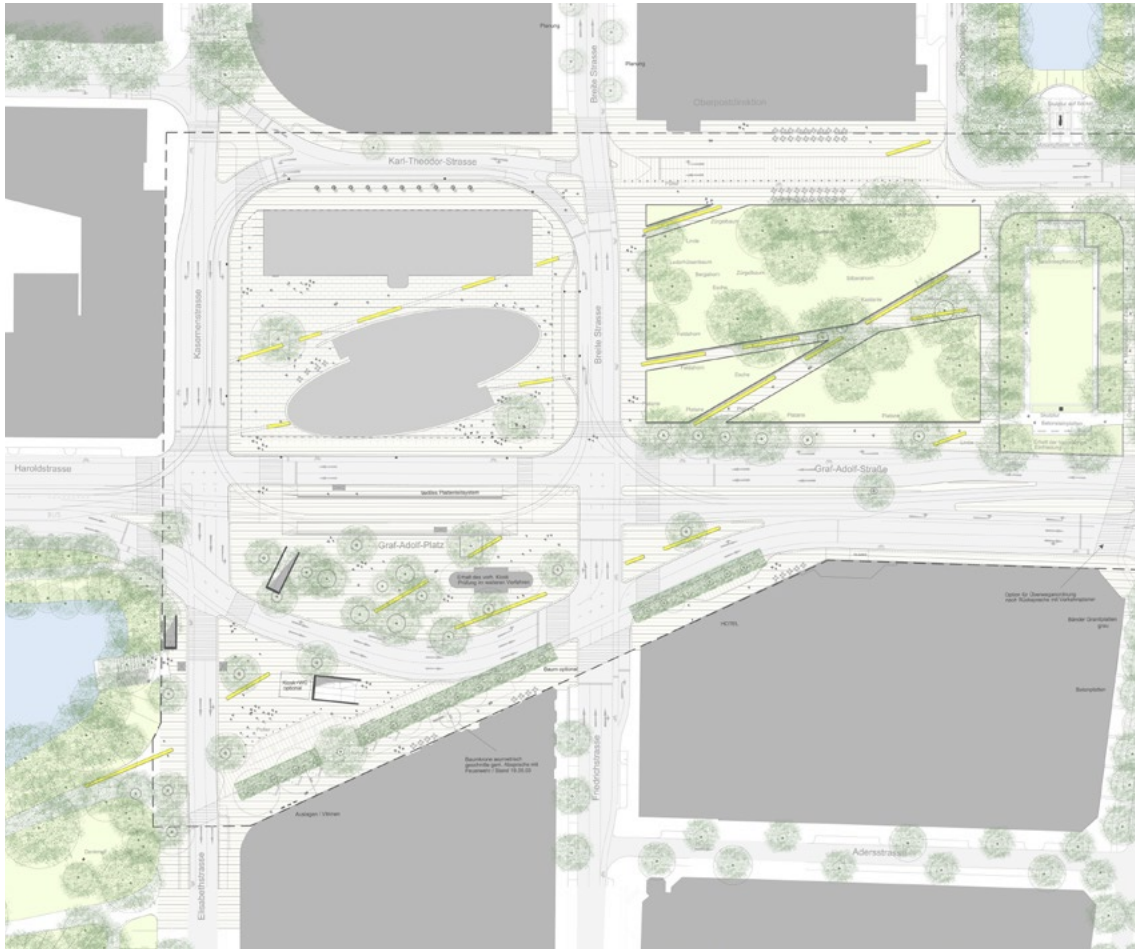

CONTACT

Jarrestraße 80
22303 Hamburg
Germany

Telephone +49 (0) 40 2 78 41-0
Telefax +49 (0) 40 270 66 68
hamburg@wes-la.de

FOR MORE INFORMATION AND PRESS MATERIAL

Telephone +49 (0) 40 2 78 41-153
Telefax +49 (0) 40 270 66 68
pr@wes-la.de

Legal notice

WES GmbH
LandschaftsArchitektur (LandscapeArchitecture)

Managing Shareholders:

Peter Schatz
Wolfgang Betz
Michael Kaschke
Henrike Wehberg-Krafft

Managing Director:

Claus Rödding

District court Hamburg HRB 100420

Person responsible for content according to
§ 55 Abs. 2 RStV: Wolfgang Betz (address as above)

The rules of professional conduct are specified in:

- (1) Chamber of Construction Law Hamburg
(BauKaG HH)
- (2) Implementing regulations for Chamber of
Construction Law (DVO BauKaG HH)
- (3) Main statute of Hamburg Chamber of Architects

The professional regulations can be viewed and
accessed via the website of the Hamburg Chamber of
Architects www.akhh.de / Section: Recht (legal issues).

The legal occupational title "Landschaftsarchitekt"
(landscape architect) was awarded to WES & Partner
GbR in Germany following their entry in the list of ar-
chitects of the Hamburg Chamber of Architects.

Hamburgische Architektenkammer
(Hamburg Chamber of Architects)

Grindelhof 40
20146 Hamburg
Telephone: +49 (0)40 441841-0
Telefax: +49 (0)40 441841-44
info@akhh.de
www.akhh.de

Copyright

The contents and works produced by the site operator
are subject to German copyright laws. The duplication,
editing, distribution and any kind of use beyond what
is permitted by the copyright laws requires written
authorisation from the respective author or content
creator.

Image rights

WES GmbH LandscapeArchitecture owns the unlimi-
ted usage rights and non-exclusive rights for all of the
image material that appears in this document.

In the context of the use of the external image material
we are exempt from any claims by third parties. WES
GmbH LandscapeArchitecture is not liable for images
provided by the project partners.

By providing image material, the project partners
avouch that they have unrestricted use of the image
material, that it is not subject to rights by third parties,
the persons pictured consent to the publication and
that no fees must be paid for this.

Links to photographers

Photos + siteplan: WES LandschaftsArchitektur
www.wes-la.de

Photos: Till Engels
till-engels.com

Model: Studio Koslowski
www.studio-koslowski.de

CONTACT

Jarrestraße 80
22303 Hamburg
Germany

Telephone +49 (0) 40 2 78 41-0
Telefax +49 (0) 40 270 66 68
hamburg@wes-la.de

FOR MORE INFORMATION AND PRESS MATERIAL

Telephone +49 (0) 40 2 78 41-153
Telefax +49 (0) 40 270 66 68
pr@wes-la.de